



4-IN-1 IMMERSION BLENDER

MM19501-BRN / MM19501-BLU



INSTRUCTION MANUAL

Read this booklet thoroughly before using
and save for future reference.

IMPORTANT SAFEGUARDS

Before using an electrical appliance, it is important to take necessary safety precautions. Here are some precautions that should always be followed:

WARNING:

- (1) The blade is very sharp. Handle it carefully when cleaning.
 - (2) Do not use abrasive cleaners and never immerse the Motor Unit in water for cleaning.
1. Read all instructions carefully.
 2. Before use, check if the voltage of the wall outlet corresponds with the appliance's rating plate.
 3. Do not use an appliance with a damaged cord or plug - return it to an authorized service facility for repair or examination.
 4. If the supply cord is damaged, have it replaced by the manufacturer or a qualified technician to avoid hazards.
 5. Always disconnect the blender from the power supply before assembling, disassembling, or cleaning it. Do not let the cord hang over the edge of a table or near a hot surface.
 6. Do not immerse the upper part of the blender in water to avoid electric shock.
 7. Keep children and infirm people away from the appliance when in use.
 8. Avoid contact with moving parts.
 9. Keep hands and utensils out of the container while blending to reduce the risk of injury or damage to the blender. Use a scraper only when the blender is not running.

10. The appliance cannot be used for chopping ice or blending hard and dry substances, which could blunt the blade.
11. Ensure the cutting blade is securely placed on the base before using the bowl.
12. Ensure the chopper lid is securely locked in place before using the appliance.
13. Using accessories not recommended by the manufacturer may cause injuries.
14. Do not operate the appliance for any other purpose than its intended use.
15. The appliance is not intended for use by children.
16. Save these instructions for future reference.
17. Using accessories not recommended by the manufacturer may cause injuries.
18. Press the release button and unplug the appliance before removing the lid from the jar; wait until the blades have stopped moving.
19. Remove the blade assembly before pouring contents from the jar.
20. Switch off the appliance after each use and ensure the motor has stopped completely before disassembling.
21. The metal blades are sharp, handle them with care.
22. Always hold the blade stem instead of the cutting edge while handling or cleaning the blade.
23. Misuse may cause potential injury.
24. Take care when handling sharp cutting blades, emptying

the bowl, and during cleaning.

25. Be cautious when pouring hot liquids into the blender as it can be ejected out of the appliance due to sudden steaming.

26. Supervise children when using the blender.

27. Switch off the appliance and disconnect it from the power supply before changing accessories or approaching moving parts.

28. This appliance is intended for household and similar applications.

29. Keep the appliance and its cord out of reach of children.

30. Children should not play with the appliance.

SAVE THESE INSTRUCTIONS HOUSEHOLD USE ONLY

NOTES ON THE CORD PLUG

This appliance has a polarized plug (one blade is wider than the other). To reduce the risk of electric shock, this plug will fit in a polarized outlet only one way. If the plug does not fit fully into the outlet, reverse the plug. If it still does not fit, contact a qualified electrician. Do not modify the plug in any way.

KNOW YOUR BLENDER

Suitable for blending vegetable and fruit.

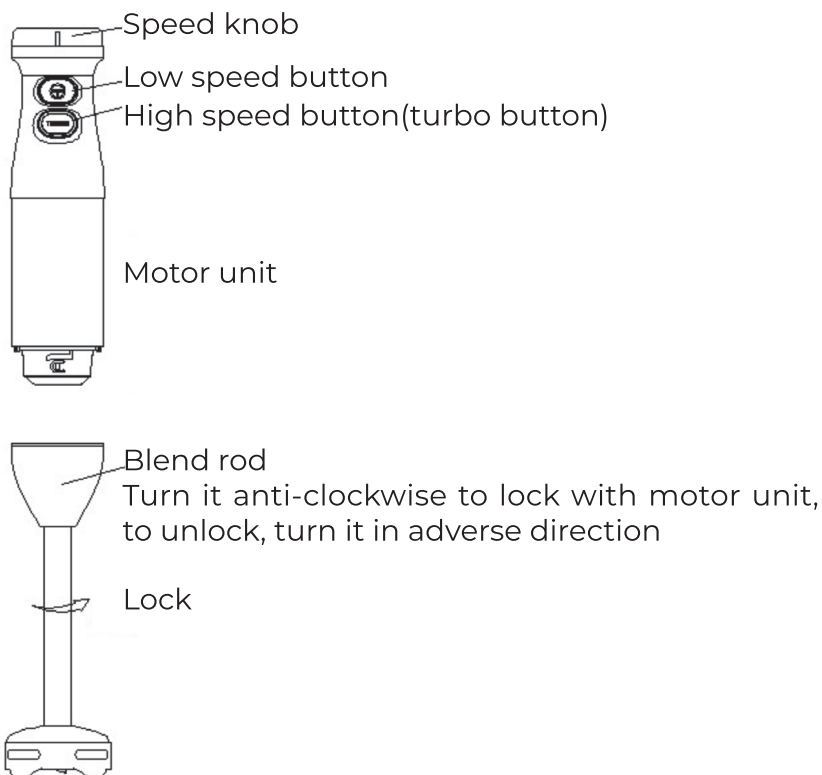

USING YOUR BLENDER

Before the first use, clean the blender according to the "Quick Cleaning" section. The time for running the unit without load should not exceed 15 seconds.

Important: The blades are very sharp, so handle with care. Ensure that the hand-held blender is unplugged from the power outlet before assembling or removing attachments.

INSTRUCTIONS FOR BLENDER

1. The maximum operation duration per cycle should not exceed 60 seconds, and a rest time of at least 3 minutes must

be observed between consecutive cycles.

2. To assemble the detachable shaft with the motor unit, turn the shaft counterclockwise until it is tightened. To disassemble, turn it in the opposite direction.

3. Simply plug the hand-held blender into the power outlet to start using it.

4. Lower the hand-held blender into the food, then press and hold either the low-speed or high-speed button to start blending.

5. Release the low-speed or high-speed button to stop the hand-held blender.

6. When blending carrots, cut them into small pieces and place them in the blending jar. The maximum quantity of carrots should not exceed 9.8 oz. Add 14.8 oz. of water for each blending.

USING YOUR CHOPPER

1. The maximum operating time per cycle should not exceed 10 seconds, and a rest time of at least 3 minutes must be observed between consecutive cycles.

2. Place the chopper bowl on a clean, level surface.

3. Assemble the stainless chopping blade into the chopper bowl as shown in the figure.

4. Place the food into the chopper bowl. Note: Remove the bone from the meat, cut it into small pieces, and place it into the bowl. The maximum quantity of meat should not exceed 7 oz. for each blending.

5. Attach the lid onto the chopper bowl by pressing it down. Detach the lid by lifting it up.

6. Insert the motor unit into the hole on the chopper lid.

7. Press and hold either the low-speed or high-speed button to start operating the hand-held blender while in the chopper. Stop the appliance by releasing the low-speed or high-speed button of the motor unit.

8. After finishing chopping, unplug the power outlet first, then remove the motor unit from the chopper lid by turning it counterclockwise.

9. Open the chopper lid by turning it counterclockwise and remove the chopped food.

CAUTION

- To reduce the risk of injury, always ensure that you have properly placed the bowl before putting the cutting blade on the base.
- Before operating the appliance, ensure that the chopper lid is securely locked in place.
- For safety purposes, disassemble the motor unit from the chopper lid first after operation, then remove the chopper lid. Do not attempt to remove the chopper lid with the motor unit still in place.

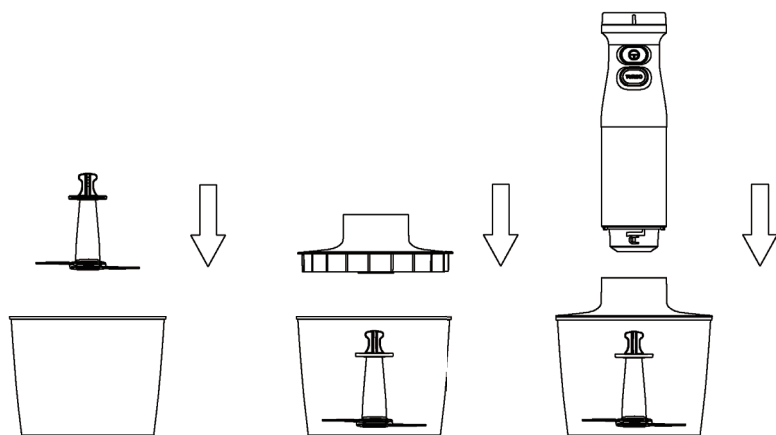

KNOW YOUR WHISK

Suitable for mixing egg whites



Motor unit

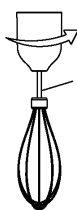

Lock

Whisk(Ideal for whisking egg white)

Turn it anti-clockwise to lock with motor unit, to lock, turn it in adverse direction



Blending jar with a measurement scale capacity 24oz. Ideal for preparing small amount of processed food

Note: The blending jar can be only used for blending food, please clean it immediately. After each use, never use it to store food

USING YOUR WHISK

MAX OPERATION DURATION PER TIME CANNOT EXCEED 1 MINUTE, AND A 3-MINUTE REST TIME MUST BE MAINTAINED BETWEEN TWO CONSECUTIVE CYCLES.

1. To assemble the egg white beater with the motor unit, turn the whisk counterclockwise until it is tightened. To disassemble, turn it clockwise.
2. Simply plug the hand-held blender into the power outlet to start using it.
3. Place the egg whites into the cup. Generally, two egg whites are enough.

4. Lower the hand-held blender into the egg whites, then press and hold either the low-speed or high-speed button to start operating.

5. Release the low-speed or high-speed button of the motor unit to stop the hand-held blender.

CLEANING AND MAINTENANCE

1. Unplug the appliance and remove the detachable stem. Do not immerse the detachable stem in water as the lubrication on the bearings may wash away over time.

2. Wash the detachable stem under running water without using abrasive cleaners or detergents. After cleaning, place it upright to drain any water that may have gotten inside. The stem is dishwasher safe.

3. Wash the cup, bowl, beater, and blade in warm soapy water. The bowl and beater are not recommended for use in dishwashers as the plastic components can deteriorate through prolonged exposure to dishwasher cleaning.

4. Wipe the motor unit with a damp cloth, but never immerse it in water as this can cause an electric shock.

5. Dry all parts thoroughly after cleaning. Caution: The blades are very sharp, so handle them with care.

QUICK CLEANING

Between processing tasks, hold the hand-held blender in a cup half-filled with water and turn it on for a few seconds.

Customer Service Inquiries:
www.bergnerus.com
Los Angeles CA 90036

